

THE DRAWING IS THE PROPERTY OF MWP. IT IS TO BE USED ONLY FOR THE PROJECT AND SITE SPECIFICALLY IDENTIFIED. IT IS NOT TO BE REPRODUCED OR COPIED IN ANY FORM OR BY ANY MEANS, ELECTRONIC OR MECHANICAL, INCLUDING PHOTOCOPYING, RECORDING, OR BY ANY INFORMATION STORAGE AND RETRIEVAL SYSTEM, WITHOUT THE WRITTEN PERMISSION OF MWP. ANY UNAUTHORIZED REPRODUCTION OR USE OF THIS DRAWING IS A BREACH OF THE COPYRIGHT AND MAY BE PROSECUTED. THE DESIGNER AND ENGINEER ASSUME NO RESPONSIBILITY FOR THE USE OF THIS DRAWING FOR ANY PURPOSE OTHER THAN THAT FOR WHICH THE DRAWING WAS PREPARED AND PROVIDED TO THE CLIENT.

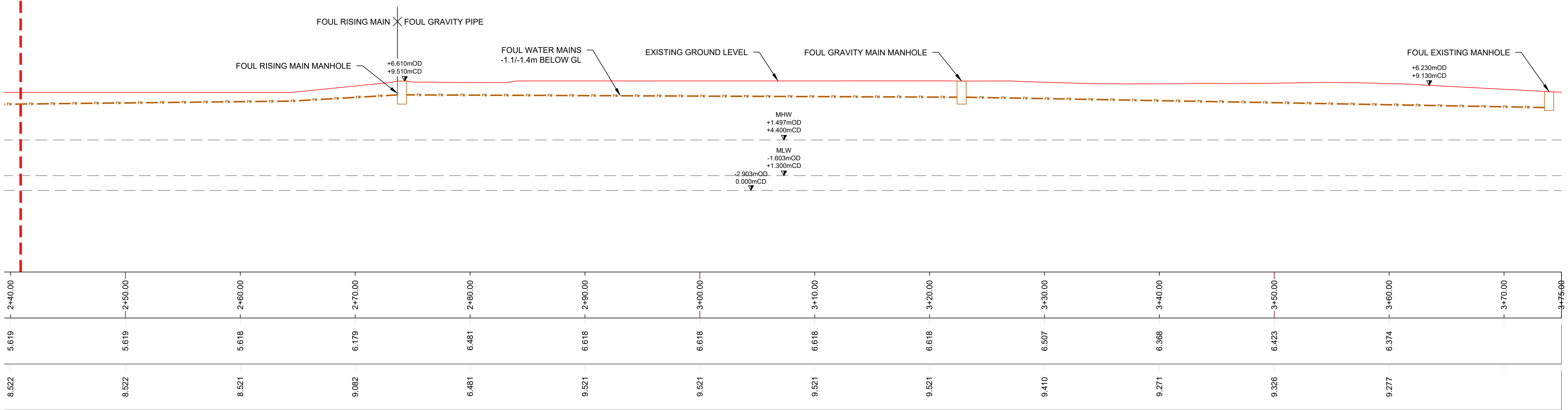
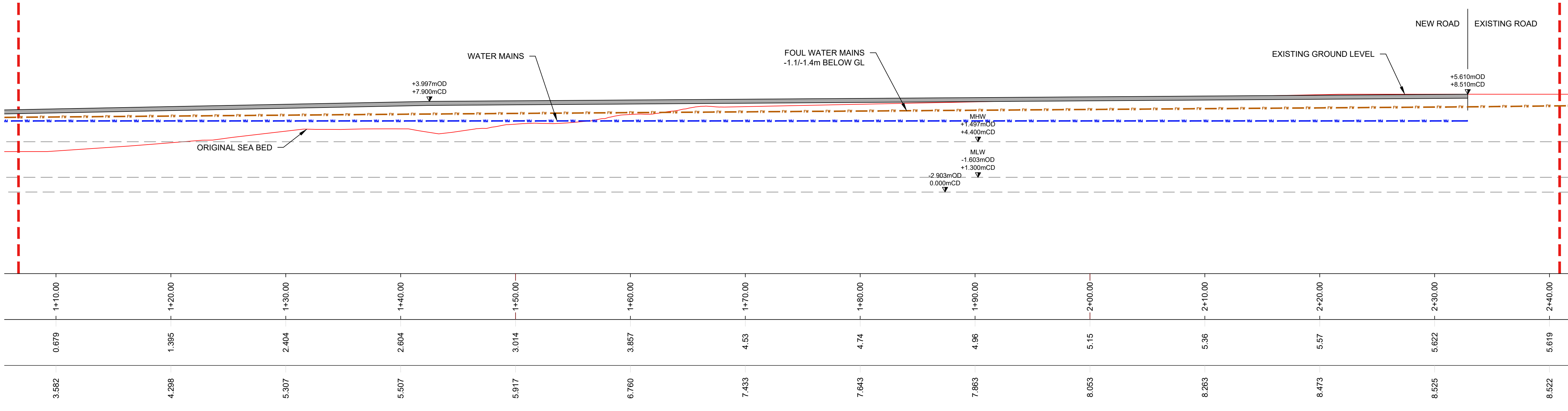
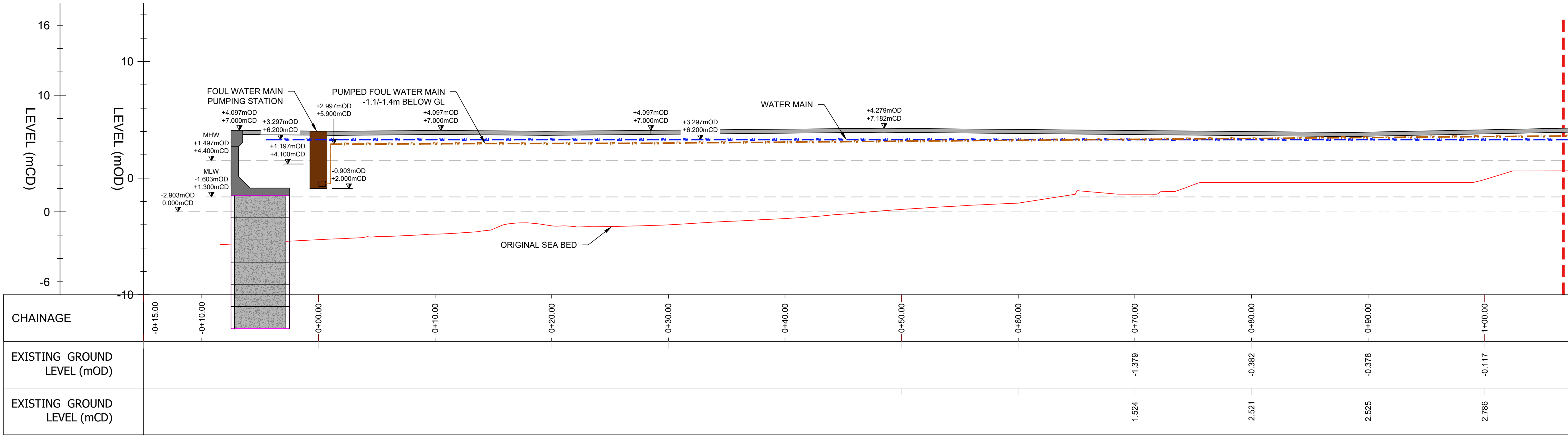

DO NOT SCALE FROM THIS DRAWING. USE FIGURED DIMENSIONS IN ALL CASES. VERIFY DIMENSIONS ON SITE AND REPORT ANY DISCREPANCIES TO THE DESIGNERS IMMEDIATELY. THIS DRAWING IS TO BE READ IN CONJUNCTION WITH THE DESIGNERS SPECIFICATION. © THIS DRAWING IS COPYRIGHT AND MAY ONLY BE REPRODUCED WITH THE DESIGNERS PERMISSION.

#### NOTES:

- ALL DRAWINGS ARE TO BE READ IN CONJUNCTION WITH ALL RELEVANT SPECIFICATIONS, BILLS OF QUANTITIES, SERVICES AND ENGINEERING DRAWINGS.
- ANY DISCREPANCIES BETWEEN THESE DOCUMENTS SHALL BE BROUGHT TO THE ATTENTION OF THE ENGINEER.
- ALL DIMENSIONS ARE IN METERS UNLESS OTHERWISE STATED.
- USE DIMENSIONS ON DRAWINGS (DO NOT SCALE FROM DRAWINGS).
- GRID AND COORDINATES ARE IN METRES RELATIVE TO I.T.M.
- ALL LEVELS ARE IN METRES RELATIVE TO CHART DATUM (CD).  
OD (MALIN) = +2.903mCD  
(POOLBEG) = +0.2mCD
- MEAN HIGH WATER (MHW) = +4.4mCD  
MEAN LOW WATER (MLW) = +1.3mCD

#### CONSTRUCTION NOTES:

- THE FOLLOWING SERVICES ARE TO BE PROVIDED TO THE BERTH AND HARDSTANDING AREA VIA SERVICE TRENCH(ES) AND/OR DUCTS:  
a) ELECTRICITY  
b) FRESH WATER  
c) FIRE FIGHTING FACILITIES  
d) TELECOMMUNICATIONS  
e) FOUL WATER DRAINAGE
- SURFACE WATER DRAINAGE IS TO BE PROVIDED CONNECTING TO SUITABLE INTERCEPTOR PITS.
- FURNITURE TO BE PROVIDED AT BERTH INCLUDES:  
a) BOLLARDS  
b) MOORING RINGS  
c) OVER-SIDE EMERGENCY LADDERS  
d) OVER-SIDE EMERGENCY LADDERS  
e) LIFE BELT MOUNTINGS  
f) SALT WATER FIRE HYDRANTS  
g) FRESH WATER HYDRANTS  
h) ELECTRICAL COMMUNICATION BOXES
- BERTH AND SECURE HARDSTANDING TO BE LIT BY MEANS OF HIGH MAST FLOODLIGHTS.

#### CONCRETE NOTES:

- STRUCTURAL CONCRETE SHOULD BE C40/50 WITH A MINIMUM CEMENT CONTENT OF 400kg/m<sup>3</sup> (>46% GGBS). MASS CONCRETE SHOULD BE C20/25.
- THE COVER FOR ALL STEEL REINFORCEMENT SHALL NOT BE LESS THAN 75MM UNLESS OTHERWISE INDICATED ON THE DRAWINGS.
- CONCRETE FINISH SHOULD BE U4.

#### GRANULAR FILL NOTE:

- CLASS 8A MATERIAL IS TO BE USED TO FORM THE CORE OF THE NEW QUAY IN THE RECLAIMED AREA.
- REFER TO VOL A: WORKS REQUIREMENTS APPENDIX 6/7 FOR SUB-GRADE AND SUB-BASE TESTING AND SURCHARGING.

#### LEGEND:

- FW PROPOSED FOUL WATER MAINS
- WM PROPOSED WATER MAINS

REFER TO  
24984-XX-XXX-DR-MWP-CE-5104  
FOR SECTION LOCATION

REV	DATE	ISSUED FOR PLANNING	DESCRIPTION	JK	CF
0	21.11.25				

PROJECT: ROS AN MHIIL DEEP WATER QUAY

TITLE: FOUL AND STORM WATER LINES LONGSECTION TO ROAD

CLIENT: DEPARTMENT OF AGRICULTURE, FOOD & THE MARINE



DRAWN: JK	CHECKED: CF	APPROVED: CF
PROJECT NUMBER: 24984	DATE: NOVEMBER 2025	SCALE @ A1: 1 : 200
ACCEPTANCE CODE: S	PURPOSE OF ISSUE: ISSUED FOR PLANNING PERMISSION	PURPOSE CODE: P3

DRAWING NUMBER: 24984-XX-XXX-DR-MWP-CE-5108	REV: 0
---	--------